

CERTIFICATE OF LOCATION OF GOVERNMENT CORNER

NORTHWEST Corner of Section 36, Township 107N, Range 40W

5th Principal Meridian, State of Minnesota, County of MURRAY

At the corner location shown on the sketch:

On 8/26/2020 found a CONCRETE MONUMENT WITH NO4 REBAR ON EAST SIDE
DATE

left monument as found lowered monument removed monument (explain)

On _____ placed a _____
DATE

SKETCH OF REFERENCE TIES

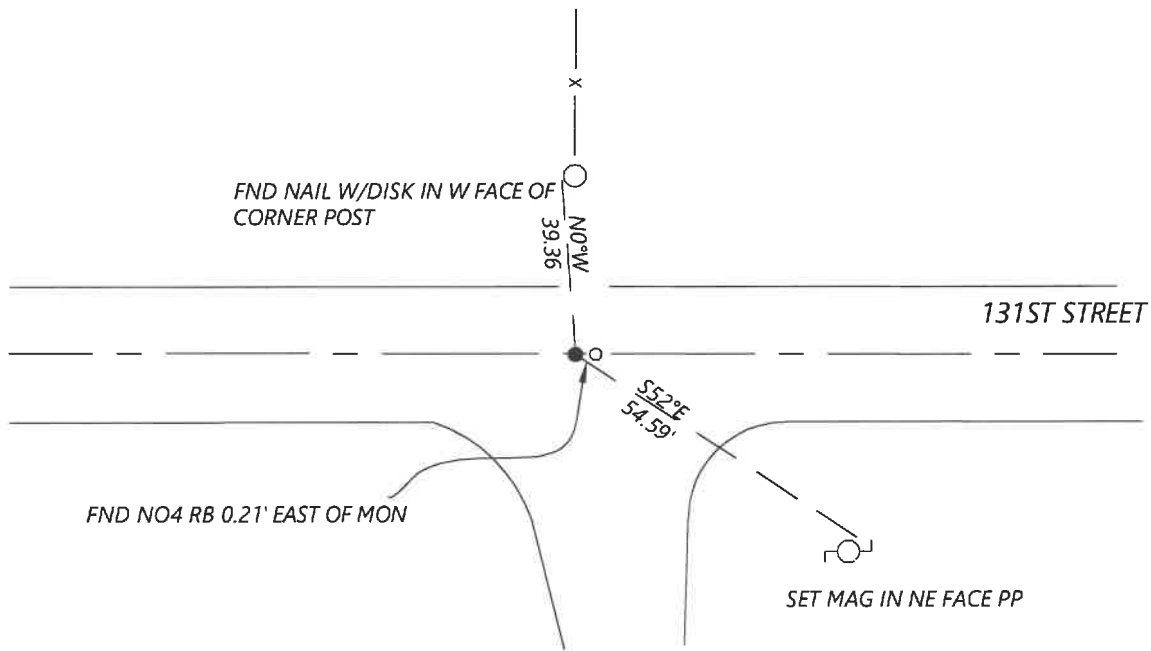

N.T.S.

Statement of evidence for this corner location is on back of this page.

I hereby certify that this document was researched and prepared by me or under my direct supervision and that I am a licensed Land Surveyor under the laws of the State of Minnesota.

Signature [Handwritten Signature]

Date 6/16/2021 License No. 45874

Title:

- Land Surveyor Professional Engineer
- County Surveyor County Engineer

OFFICE OF THE COUNTY RECORDER

County of Murray

I hereby certify that this document was filed in the Co.

Recorder's office at _____ M. on the _____ day of _____ A.D. 20 _____

County Recorder Karen Bramm

by JUN 22 2021, Deputy

DOCUMENT NO. _____

Statement of Evidence:

Northwest Corner of Section 36, Township 107 North, Range 40 West, 5th Principal Meridian, Murray County, Minnesota.

JUNE 29, 1932 - SURVEY RECORD FOR SECTION 36 SHOWS A SET CONCRETE MONUMENT, 18" LONG WITH A CROSS ON TOP. FENCE CORNER ON LINE NORTH 31.5.

AUGUST 5, 1969 - SURVEY RECORD FOR SECTION 35 SHOWS A FOUND CONCRETE BLOCK WITH "+" ON TOP. MONUMENT IS IN LINE WITH FENCE LINE SOUTH.

AUGUST 5, 1969 - HWY DEPT. RECORDS SHOW A CONCRETE MONUMENT 6" BELOW GRADE, AND PLACED A STEEL PIN ABOVE MONUMENT. N&C PP SE 54.13; N&C COR POST SW 41.57; N&C COR POST NORTH 39.30.

SEPTEMBER 2020 - WESTWOOD PROFESSIONAL SERVICES SEARCHED AND FOUND CONCRETE MONUMENT WITH #4 REBAR ON EAST SIDE, AND ALSO 1 REFERENCE TIE FROM 1969 MONUMENT IS IN ROAD CENTERLINE AND IN LINE WITH N/S FENCE. ACCEPTED THE FOUND MONUMENT AND SET ADDITIONAL TIES.

Analysis of the recovered data, field evidence and survey measurements, indicates that the monument found is the correct perpetuation of this corner. For additional information concerning this corner please contact Westwood Professional Services.